

POWDER COATED

Powder coated steel partitions provide high-tech quality at an economical price. The powder coated finish is electrostatically applied over galvanized steel. The finish is highly resistant to wear, fading, staining, scratching and scuffing. It is easily cleaned with mild soap and wiped dry.

The steel is electrogalvanized to protect against corrosion and provide a proper base for the finish. The face sheets are held rigid and permanently in place by an interlocking strip welded at each corner. The core is cellular honeycomb which provides strong construction and maximum sound attenuation.

Global Partitions offers a full color palette of popular colors for design flexibility.

FAST TRACK: 48 Hour Shipping

Available in all standard colors shown below — Floor Anchored/Overhead Braced only.



COLOR SELECTION:



OPTIONS:

- Wood Core
- No Sight Hardware
- Continuous Aluminum Brackets
- Continuous Stainless Steel Brackets
- Continuous Powder Coated Brackets
- Ultimate Privacy™ Height Options
- Stainless Steel Stirrup Brackets & Door Hardware

CONSTRUCTION FEATURES:

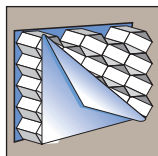

Honeycomb Core
Made of cellular honeycomb. This type of core provides strong construction and sound attenuation.

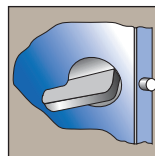

Concealed Latch
With emergency access and ADA lever handle.

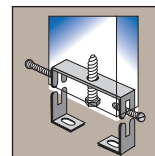

Pilaster Mounting
Pilaster adjustments, with floor-mounted jack-leveling device is standard on floor anchored/overhead braced pilasters.

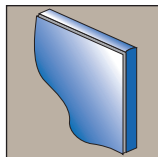

Welded Corner
Corners of panels, pilasters and doors are welded to each other and to the adjacent face sheets.

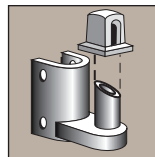

Bottom Door Hinge
Gravity-positioning hinge provides safe, durable and maintenance free support.

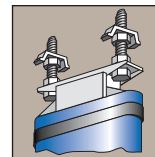

Alternate Pilaster Mounting
This heavy gauge mounting is furnished on all ceiling hung and floor anchored pilasters.

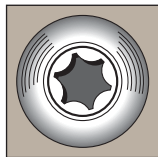

Vandal-Resistant Fasteners
Special driver installs fasteners which virtually eliminates unauthorized removal and ensures easy installation.

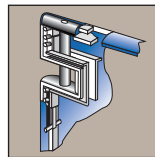

Upper Door Bracket
Internal part of the door. A pin goes through door and bracket for three-point bearing and operates in a nylon bushing in upper hinge bracket.

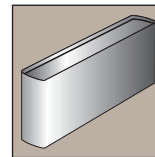

Shoe Construction
One-piece stainless steel, type 304, with #4 satin finish trim shoes are hemmed top and bottom for rigidity and sleek appearance.